

BS-4000(12) Backscan®

Fitting instructions

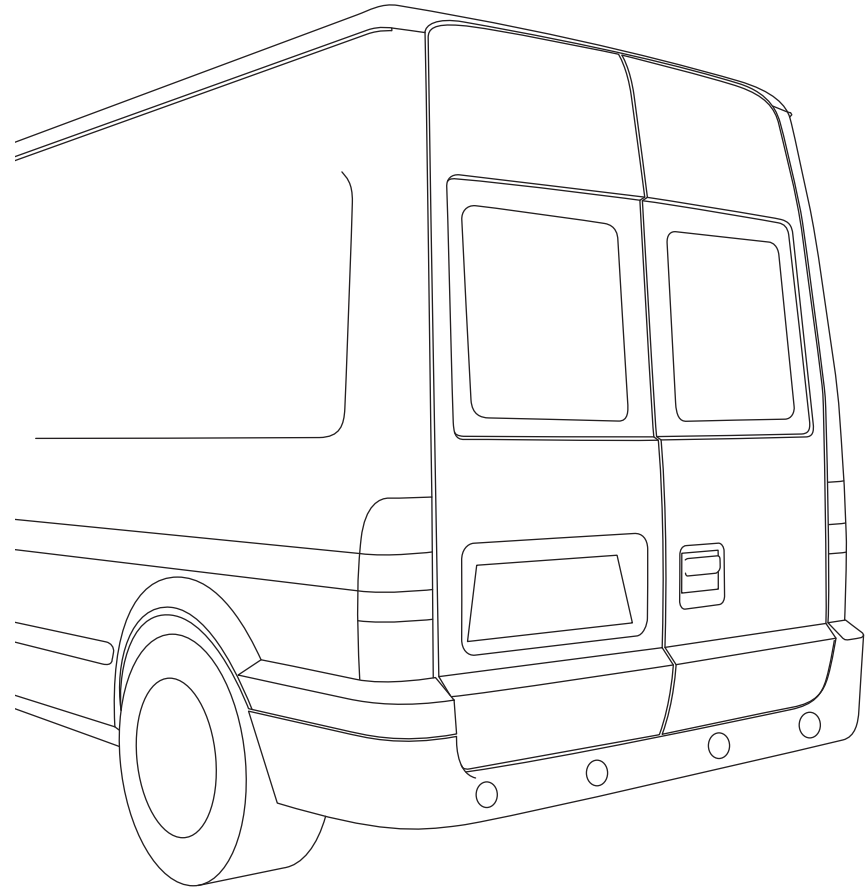

Backscan BS-4000(12)

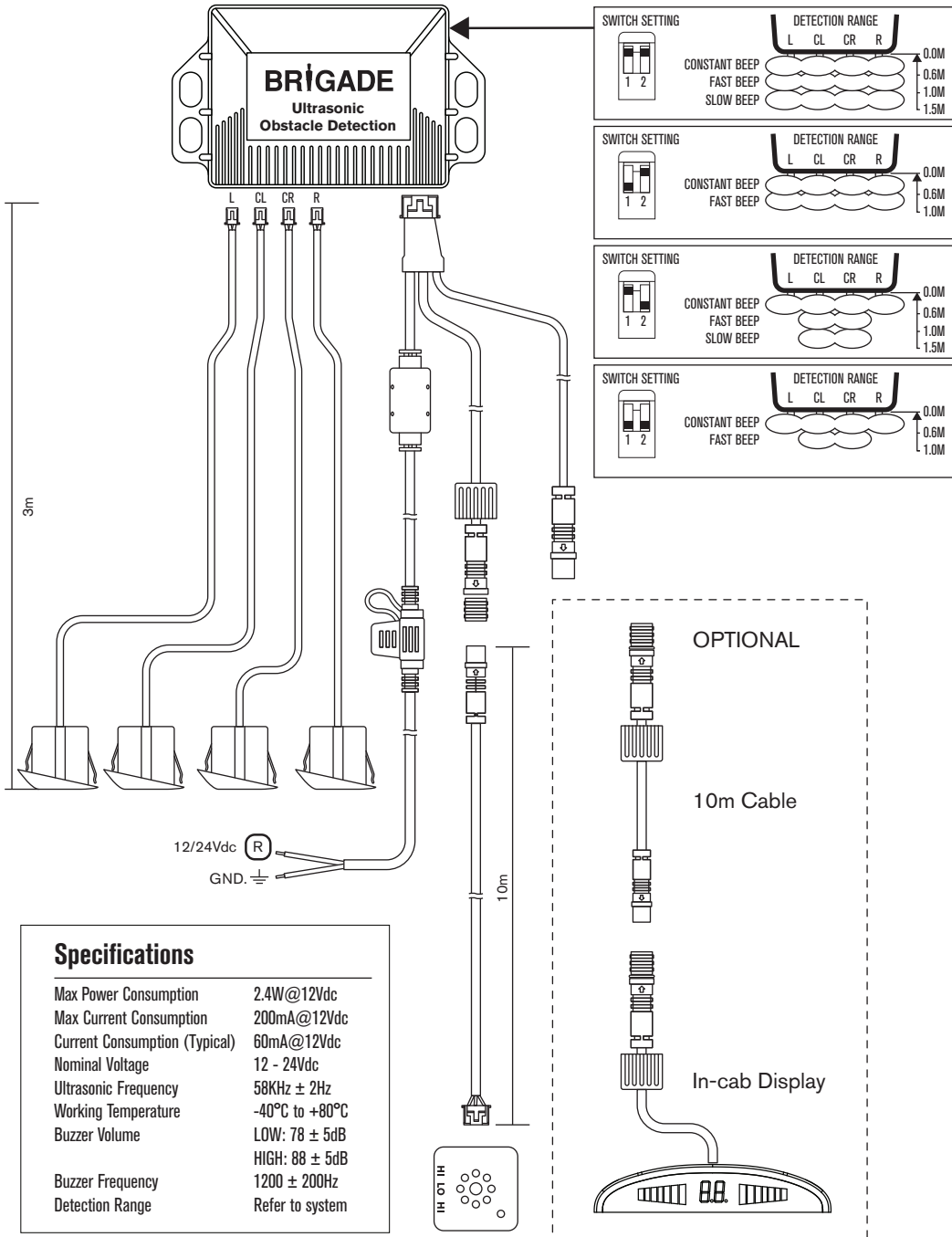

Specifications

Max Power Consumption	2.4W@12Vdc
Max Current Consumption	200mA@12Vdc
Current Consumption (Typical)	60mA@12Vdc
Nominal Voltage	12 - 24Vdc
Ultrasonic Frequency	58KHz ± 2Hz
Working Temperature	-40°C to +80°C
Buzzer Volume	LOW: 78 ± 5dB HIGH: 88 ± 5dB
Buzzer Frequency	1200 ± 200Hz
Detection Range	Refer to system

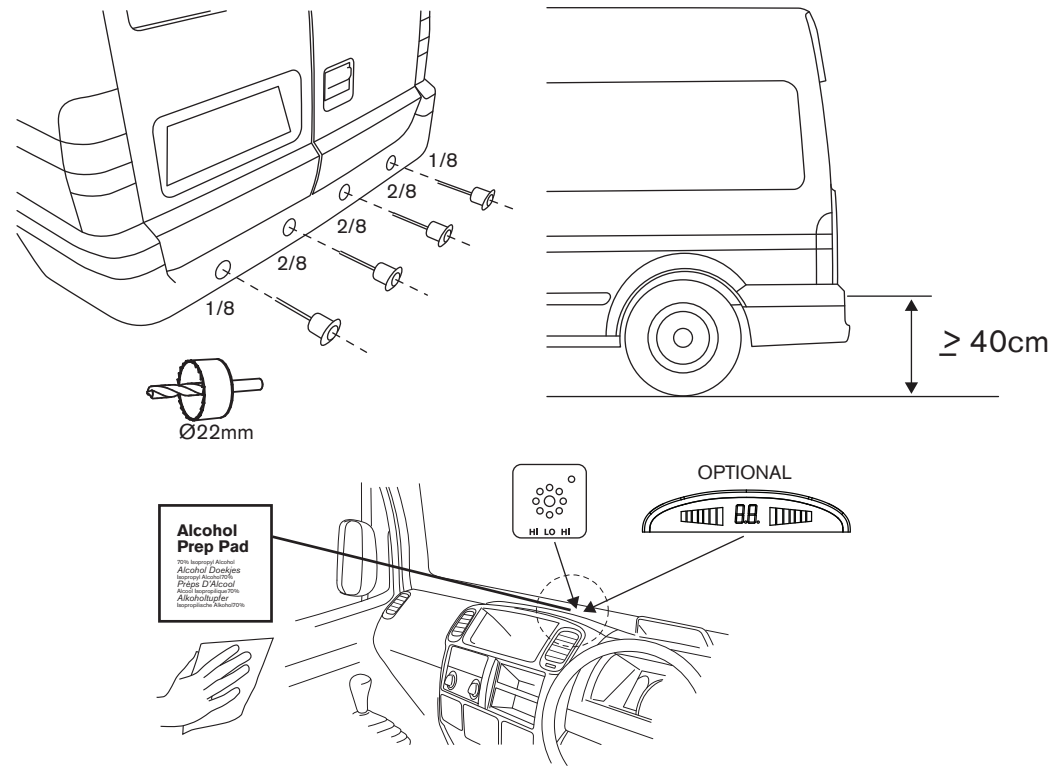

Diagnostics:

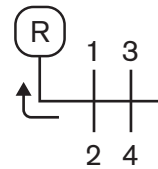

= 'BLEEP' x 1
System OK

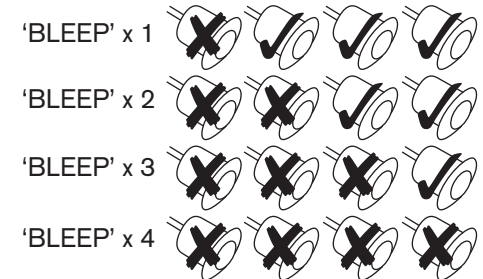

Environment Learning Mode:

Ignores permanently fixed objects, eg a tow bar

Object detected

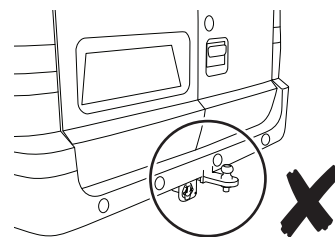

Engage Reverse

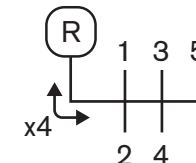

Object ignored

